

MrPEX® F2159 PPSU FITTINGS SUBMITTAL



5300 Alpine Drive NW, Suite 210
 Ramsey, MN 55303
 support@mrpexsystems.com

Project Name _____ Date _____
 Submitted By _____ Phone _____
 Project Location _____ MrPEX® Rep. _____
 Engineer _____ Contractor _____
 Approval _____ P.O. Number _____

MrPEX® F2159 PPSU PEX PRESS FITTINGS

MrPEX® plastic fittings are made from a blend of engineered high performance PolyPhenylSulfone (PPSU) resin to achieve a long-term durable product. These PPSU fittings are durable, light weight, corrosion free, and resistant to chlorine and other substances that may be present in today's potable water supply. The Sulfone resin has been used and refined over the past 20 years and has proven a very reliable replacement for brass and copper fittings. MrPEX® fittings are listed to ASTM F2159. MrPEX® Stainless Steel Press Sleeves and PEX Press tools are required and purchased separately.



Technical Data

Material	PolyPhenylSulfone
Operating Pressure Rating	180° F@ 100 psi

Standards

- ASTM F2159
- ASTM F877
- NSF/ANSI 14
- NSF/ANSI 61
- NSF/ANSI 61 Annex G
- CSA B137.5

Barb Size	ID	OD
1/2"	0.32"	0.47"
3/4"	0.46"	0.67"
1"	0.62"	0.86"

Listings

- IAPMO
- UPC
- cNSFuspw

Part #	Type	A	B	C
4015050	1/2" PEX to 1/2" PEX	1.52"	0.63"	0.10"
4017575	3/4" PEX to 3/4" PEX	1.52"	0.83"	0.10"
4011010	1" PEX to 1" PEX	1.84"	0.99"	0.13"

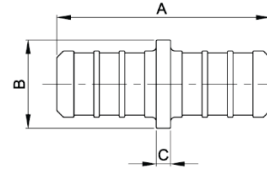

Part #	Type	A	B	C	D
4065050	1/2" PEX to 1/2" PEX	1.40"	1.40"	1.16"	1.16"
4067550	3/4" PEX to 1/2" PEX	1.64"	1.64"	1.26"	1.26"
4067575	3/4" PEX to 3/4" PEX	1.64"	1.64"	1.26"	1.26"
4061010	1" PEX to 1" PEX	2.00"	2.00"	1.53"	1.53"

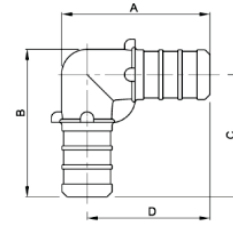

Part #	Type	A	B	C
4040500	1/2" PEX	0.84"	0.63"	0.13"
4040750	3/4" PEX	0.85"	0.83"	0.13"
4041000	1" PEX	1.00"	0.98"	0.14"

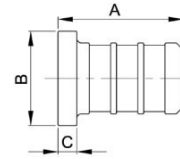

Part #	Type	A	B	C
4025050	1/2" PEX to 1/2" NPT	1.68"	0.87"	1/2" NPT
4025075	1/2" PEX to 3/4" NPT	1.70"	1.00"	3/4" NPT
4027575	3/4" PEX to 3/4" NPT	1.70"	1.00"	3/4" NPT
4021010	1" PEX to 1" NPT	2.04"	1.31"	1" NPT

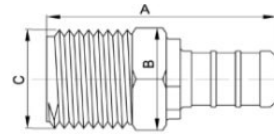

Part #	Type	A	B	C	D
4035050	1/2" PEX to 1/2" FPT	1.59"	1.08"	1.02"	1/2" NPT
4037575	3/4" PEX to 3/4" FPT	1.66"	1.25"	1.25"	3/4" NPT
4031010	1" PEX to 1" FPT	1.74"	1.47"	1.46"	1" NPT

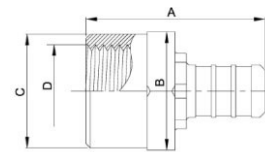

Part #	Type	A	B	C
4095055	1/2" PEX x 1/2" PEX x 1/2" PEX	2.32"	1.16"	1.16"
4095057	1/2" PEX x 1/2" PEX x 3/4" PEX	2.52"	1.26"	1.26"
4097555	3/4" PEX x 1/2" PEX x 1/2" PEX	2.40"	1.16"	1.16"
4097557	3/4" PEX x 1/2" PEX x 3/4" PEX	2.52"	1.26"	1.26"
4097571	3/4" PEX x 3/4" PEX x 1" PEX	2.6"	1.3"	1.36"
4097575	3/4" PEX x 3/4" PEX x 1/2" PEX	2.52"	1.26"	1.26"
4097577	3/4" PEX x 3/4" PEX x 3/4" PEX	2.52"	1.26"	1.26"
4091011	1" PEX x 1" PEX x 1" PEX	3.05"	1.53"	1.53"
4091015	1" PEX x 1" PEX x 1/2" PEX	2.68"	1.34"	1.33"
4091017	1" PEX x 1" PEX x 3/4" PEX	2.68"	1.34"	1.33"
4091071	1" PEX x 3/4" PEX x 1" PEX	2.82"	1.48"	1.53"
4091077	1" PEX x 3/4" PEX x 3/4" PEX	2.68"	1.34"	1.33"

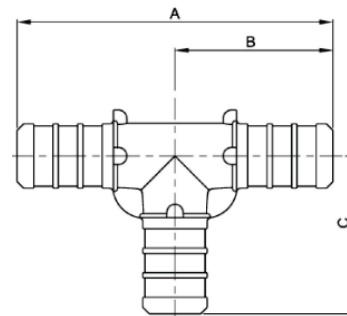

Part #	Type	A	B	C	D
4040500	1/2" PEX to 1/2" NPT Elbow	1.46"	1.16"	0.75"	1/2" NPT

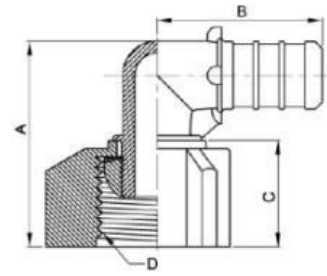

Part #	Type	A	B	C	D
4040500	1/2" PEX to 1/2" NPT Straight	1.47"	0.75"	0.13"	1/2" NPT

