

MrPEX® SURFACE MANIFOLD CABINETS SUBMITTAL



MrPEX
SYSTEMS

14799 Jackal St NW Suite 100
Ramsley, MN 55303
support@mrpexsystems.com

Project Name _____ Date _____
Submitted By _____ Phone _____
Project Location _____ MrPEX® Rep. _____
Engineer _____ Contractor _____
Approval _____ P.O. Number _____

Surface mounted cabinets for MrPEX® manifolds

MrPEX® Surface manifold cabinets allows for a neat and professional installation in areas where the manifold might otherwise be visible or subject to damage. Cabinets are made from hot-dipped 20 Gauge galvanized steel. To save on space and to reduce damage during shipping, cabinets come boxed flat and un-assembled. Also featuring; a durable white finish, door with latch, adjustable manifold mounting brackets Inside the cabinet, and a removable door and lower section for easy access during installation.

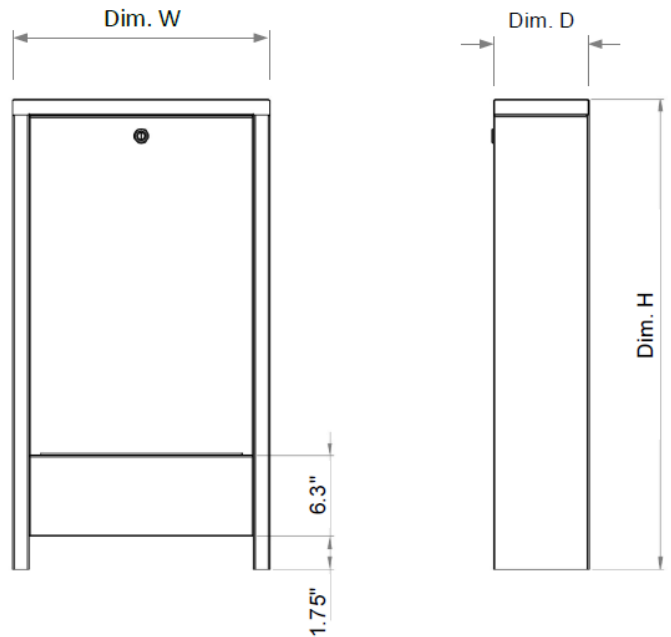

Manifold Cabinets

Part #	Description	Type	Unit
6212421	Manifold Cabinet, Un-assembled, W20.8", H27.2", D4.3"-6.3"	Surface	Each
6212431	Manifold Cabinet, Un-assembled, W26.8", H27.2", D4.3"-6.3"	Surface	Each
6212451	Manifold Cabinet, Un-assembled, W40.5", H27.2", D4.3"-6.3"	Surface	Each

Manifold Cabinet Selection Chart

Part #	1 1/4" Stainless	1 1/4" Stainless	Composite	1 1/2" Stainless	1 1/2" Brass
	No Ball Valve	With Ball Valve			
6212421	Up to 7 loops	Up to 6 Loops	Up to 6 Loops	Up to 4 Loops	Up to 5 Loops
6212431	Up to 11 Loops	Up to 10 Loops	Up to 10 Loops	Up to 8 Loops	Up to 8 Loops
6212451	UP to 12 Loops	Up to 12 Loops	Up to 12 Loops	Up to 10 Loops	Up to 12 Loops